

Innehållsförteckning: Syrafasta slangkopplingar

SFP 8	Rak koppling	Inv G-gänga	sid	73
SFP 3	Rak koppling	UtvG-gänga	sid	74
SFP 39	Vinkelkoppling 90	Inv G-gänga	sid	75
SFP 40	Vinkelkoppling 45	Inv G-gänga	sid	76
SFP 77	Rak koppling	Inv G-gänga plan	sid	77
SFP 86	Rak koppling	Inv MM-gänga	sid	78
SFP 87	Vinkelkoppling 90 DKO	Inv MM-gänga	sid	79
SFP 88	Vinkelkoppling 45 DKO	Inv MM-gänga	sid	80
SFP 35	Rörstuds		sid	81
SFP 36	Rörstuds 45°		sid	82
SFP 37	Rörstuds 90°		sid	83
SFP 85	Rak koppling SK	Utv MM-gänga	sid	84
SFP 84	Rak koppling	Inv UNF-gänga	sid	85
SFP 34	Rak koppling	Utv UNF-gänga	sid	86
SFP 49	Vinkelkoppling 90	Inv UNF-gänga	sid	87
SFP 50	Vinkelkoppling 45	Inv UNF-gänga	sid	88
SFP 6	Rak koppling	Utv NPT-gänga	sid	89
SFP 4	Rak koppling	Plan G-gänga	sid	90
SFP 9	Rak koppling	Utv BSPT-gänga	sid	91
SFP 603-606	Rak koppling SAE 3000, SAE 6000		sid	92
SFP 613-616	Vinkelkoppling 90, SAE 3000, SAE 6000		sid	93
SFP 81	Banjo		sid	94
SFP 181	Banjoskruv		sid	95
RGN	Banjohus		sid	95
SFP 10 o 20	Hylsor 1w, 2w skalas		sid	96
SFPT	Hylsor 1w, 2w skalfri		sid	97
SFP R7	Hylsa R7		sid	98
PTFE	Hylsa PTFE		sid	99

Rak koppling invändig BSPP-gänga

Syrafast stål

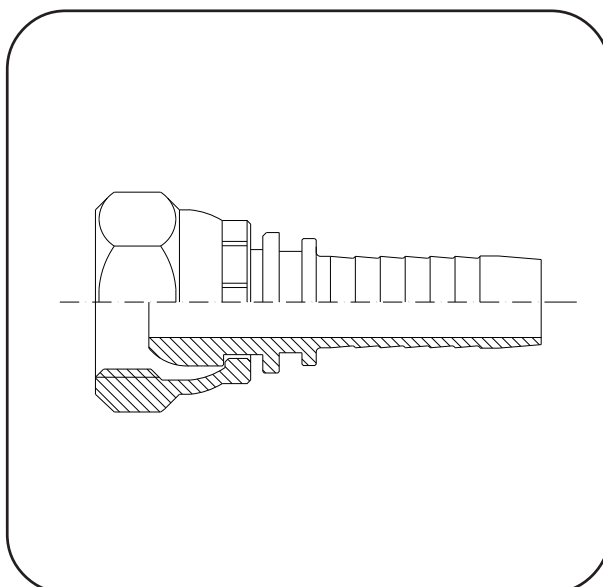

Typ: SFP 8

Beteckning	Slanginnerdiameter	Anslutning	Pris/st
SFP 8-04-02	1/4"	G 1/8"	348 kr
SFP 8-04-06	1/4"	G 3/8"	491 kr
SFP 8-04	1/4"	G 1/4"	348 kr
SFP 8-05-06	5/16"	G 3/8"	437 kr
SFP 8-06	3/8"	G 3/8"	388 kr
SFP 8-06-04	3/8"	G 1/4"	407 kr
SFP 8-06-08	3/8"	G 1/2"	468 kr
SFP 8-08-06	1/2"	G 3/8"	592 kr
SFP 8-08	1/2"	G 1/2"	432 kr
SFP 8-08-12	1/2"	G 3/4"	529 kr
SFP 8-10	5/8"	G 5/8"	595 kr
SFP 8-10-12	5/8"	G 3/4"	700 kr
SFP 8-12	3/4"	G 3/4"	584 kr
SFP 8-12-16	3/4"	G 1"	846 kr
SFP 8-16	1"	G 1"	823 kr
SFP 8-20	1.1/4"	G 1.1/4"	1 230 kr
SFP 8-24	1.1/2"	G 1.1/2"	1 906 kr
SFP 8-32	2"	G 2"	2 796 kr

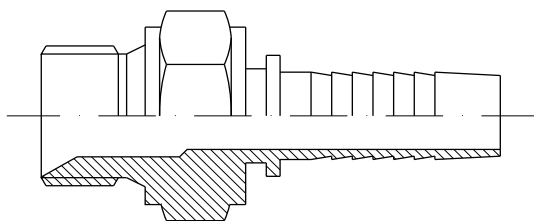

Rak koppling utvändig BSPP-gänga

Syrafast stål

Typ: SFP 3

Beteckning	Slanginnerdiameter	Anslutning	Pris/st
SFP 3-04-02	1/4"	G 1/8"	373 kr
SFP 3-04	1/4"	G 1/4"	372 kr
SFP 3-04-06	1/4"	G 3/8"	372 kr
SFP 3-06	3/8"	G 3/8"	376 kr
SFP 3-06-04	3/8"	G 1/4"	379 kr
SFP 3-06-08	3/8"	G 1/2"	547 kr
SFP 3-08	1/2"	G 1/2"	450 kr
SFP 3-08-06	1/2"	G 3/8"	452 kr
SFP 3-08-12	1/2"	G 3/4"	717 kr
SFP 3-10-08	5/8"	G 1/2"	643 kr
SFP 3-10	5/8"	G 5/8"	808 kr
SFP 3-10-12	5/8"	G 3/4"	674 kr
SFP 3-12-08	3/4"	G 1/2"	677 kr
SFP 3-12	3/4"	G 3/4"	643 kr
SFP 3-12-16	3/4"	G 1"	955 kr
SFP 3-16	1"	G 1"	942 kr
SFP 3-16-12	1"	G 3/4"	931 kr
SFP 3-16-20	1"	G 1.1/4"	1 796 kr
SFP 3-20	1.1/4"	G 1.1/4"	1 717 kr
SFP 3-24	1.1/2"	G 1.1/2"	1 832 kr
SFP 3-32	2"	G 2"	2 956 kr

Vinkelkoppling 90° invändig BSPP-gänga

Syrafast stål

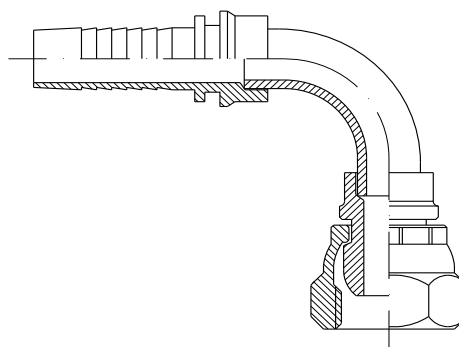

Typ: SFP 39

Beteckning	Slanginnerdiameter	Anslutning	Pris/st
SFP 39-04	1/4"	G 1/4"	566 kr
SFP 39-06	3/8"	G 3/8"	620 kr
SFP 39-06-08	3/8"	G 1/2"	909 kr
SFP 39-08	1/2"	G 1/2"	822 kr
SFP 39-08-12	1/2"	G 3/4"	1 199 kr
SFP 39-10	5/8"	G 5/8"	964 kr
SFP 39-12	3/4"	G 3/4"	1 089 kr
SFP 39-12-16	3/4"	G 1"	1 659 kr
SFP 39-16	1"	G 1"	1 597 kr
SFP 39-20	1.1/4"	G 1.1/4"	2 892 kr
SFP 39-24	1.1/2"	G 1.1/2"	3 314 kr
SFP 39-32	2"	G 2"	5 261 kr

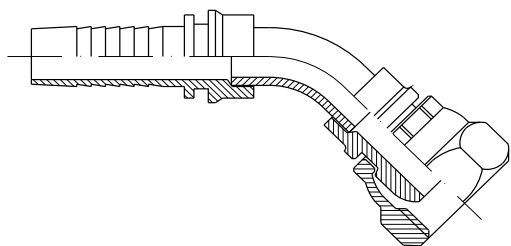

Vinkelkoppling 45° invändig BSPP-gänga

Syrafast stål

Typ: SFP 40

Beteckning	Slanginnerdiameter	Anslutning	Pris/st
SFP 40-04	1/4"	G 1/4"	566 kr
SFP 40-06	3/8"	G 3/8"	620 kr
SFP 40-06-08	3/8"	G 1/2"	909 kr
SFP 40-08	1/2"	G 1/2"	822 kr
SFP 40-10	5/8"	G 5/8"	964 kr
SFP 40-12	3/4"	G 3/4"	1 089 kr
SFP 40-12-16	3/4"	G 1"	1 659 kr
SFP 40-16	1"	G 1"	1 597 kr
SFP 40-20	1.1/4"	G 1.1/4"	2 892 kr
SFP 40-24	1.1/2"	G 1.1/2"	3 314 kr
SFP 40-32	2"	G 2"	5 261 kr

Rak koppling invändig BSPP-gänga plan

Syrafast stål

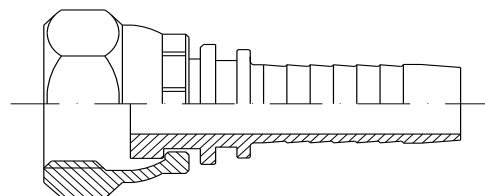

Typ: SFP 77

Beteckning	Slanginnerdiameter	Anslutning	Pris/st
SFP 77-04	1/4"	G 1/4"	501 kr
SFP 77-06	3/8"	G 3/8"	473 kr
SFP 77-06-08	3/8"	G 1/2"	501 kr
SFP 77-08	1/2"	G 1/2"	501 kr
SFP 77-08-12	1/2"	G 3/4"	694 kr
SFP 77-10	5/8"	G 5/8"	643 kr
SFP 77-10-12	5/8"	G 3/4"	643 kr
SFP 77-12	3/4"	G 3/4"	624 kr
SFP 77-12-16	3/4"	G 1"	919 kr
SFP 77-16	1"	G 1"	909 kr
SFP 77-20	1.1/4"	G 1.1/4"	1 377 kr
SFP 77-24	1.1/2"	G 1.1/2"	1 906 kr
SFP 77-24-32	1.1/2"	G 2"	2 725 kr
SFP 77-32	2"	G 2"	2 796 kr

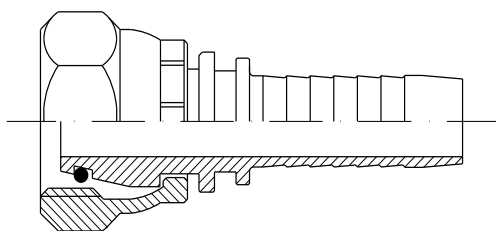

Rak koppling DKO invändig MM-gänga

Syrafast stål

Typ: SFP 86

Beteckning	Slanginnerdiameter	Anslutning	Pris/st
SFP 86-04-06L	1/4"	M 12x1,5	428 kr
SFP 86-04-08L	1/4"	M 14x1,5	413 kr
SFP 86-04-10L	1/4"	M 16x1,5	519 kr
SFP 86-06-10L	3/8"	M 16x1,5	565 kr
SFP 86 06-12L	3/8"	M 18x1,5	428 kr
SFP 86-06-15L	3/8"	M 22x1,5	477 kr
SFP 86-08-15L	1/2"	M 22x1,5	428 kr
SFP 86-08-18L	1/2"	M 26x1,5	538 kr
SFP 86-10-18L	5/8"	M 26x1,5	538 kr
SFP 86-10-22L	5/8"	M 30x2,0	630 kr
SFP 86-12-22L	3/4"	M 30x2,0	578 kr
SFP 86-16-28L	1"	M 36x2,0	863 kr
SFP 86-20-35L	1.1/4"	M 45x2,0	1 662 kr
SFP 86-24-42L	1.1/2"	M 52x2,0	2 011 kr
SFP 86-04-06S	1/4"	M 14x1,5	428 kr
SFP 86-04-08S	1/4"	M 16x1,5	409 kr
SFP 86-04-10S	1/4"	M 18x1,5	422 kr
SFP 86-06-10S	3/8"	M 18x1,5	519 kr
SFP 86-06-12S	3/8"	M 20x1,5	428 kr
SFP 86 06-14S	3/8"	M 22x1,5	432 kr
SFP 86-08-16S	1/2"	M 24x1,5	418 kr
SFP 86-10-20S	5/8"	M 30x2,0	578 kr
SFP 86-12-20S	3/4"	M 30x2,0	936 kr
SFP 86-12-25S	3/4"	M 36x2,0	863 kr
SFP 86-16-25S	1"	M 36x2,0	1 272 kr
SFP 86-16-30S	1"	M 42x2,0	1 010 kr
SFP 86-20-38S	1.1/4"	M 52x2,0	1 636 kr

Vinkelkoppling 90° DKO invändig MM-gänga

Syrafast stål

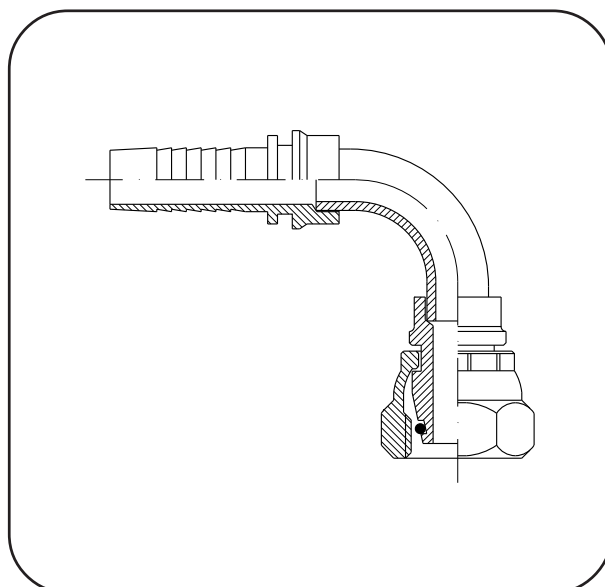

Typ: SFP 87

Beteckning	Slanginnerdiameter	Anslutning	Pris/st
SFP 87-04-06L	1/4"	M 12x1,5	814 kr
SFP 87-04-08L	1/4"	M 14x1,5	752 kr
SFP 87-04-10L	1/4"	M 16x1,5	752 kr
SFP 87-06-10L	3/8"	M 16x1,5	900 kr
SFP 87-06-12L	3/8"	M 18x1,5	835 kr
SFP 87-06-15L	3/8"	M 22x1,5	872 kr
SFP 87-08-15L	1/2"	M 22x1,5	914 kr
SFP 87-08-18L	1/2"	M 26x1,5	1 368 kr
SFP 87-10-18L	5/8"	M 26x1,5	1 129 kr
SFP 87-10-22L	5/8"	M 30x2,0	1 772 kr
SFP 87-12-22L	3/4"	M 30x2,0	1 557 kr
SFP 87-16-28L	1"	M 36x2,0	2 016 kr
SFP 87-20-35L	1.1/4"	M 45x2,0	3 856 kr
SFP 87-24-42L	1.1/2"	M 52x2,0	5 581 kr
SFP 87-04-06S	1/4"	M 14x1,5	814 kr
SFP 87-04-08S	1/4"	M 16x1,5	752 kr
SFP 87-04-10S	1/4"	M 18x1,5	835 kr
SFP 87-06-10S	3/8"	M 18x1,5	872 kr
SFP 87-06-12S	3/8"	M 20x1,5	872 kr
SFP 87-06-14S	3/8"	M 22x1,5	992 kr
SFP 87-08-16S	1/2"	M 24x1,5	1 006 kr
SFP 87-10-20S	5/8"	M 30x2,0	1 322 kr
SFP 87-12-20S	3/4"	M 30x2,0	1 649 kr
SFP 87-12-25S	3/4"	M 36x2,0	1 698 kr
SFP 87-16-25S	1"	M 36x2,0	1 928 kr
SFP 87-16-30S	1"	M 42x2,0	2 846 kr
SFP 87-20-38S	1.1/4"	M 52x2,0	4 297 kr

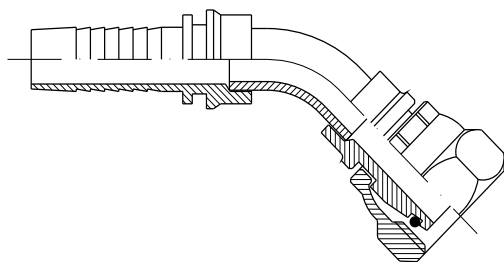

Vinkelkoppling 45° DKO invändig MM-gänga

Syrafast stål

Typ: SFP 88

Beteckning	Slanginnerdiameter	Anslutning	Pris/st
SFP 88-04-08L	1/4"	M 14x1,5	706 kr
SFP 88-04-10L	1/4"	M 16x1,5	707 kr
SFP 88-06-10L	3/8"	M 16x1,5	900 kr
SFP 88-06-12L	3/8"	M 18x1,5	564 kr
SFP 88-06-15L	3/8"	M 22x1,5	826 kr
SFP 88-08-15L	1/2"	M 22x1,5	951 kr
SFP 88-08-18L	1/2"	M 26x1,5	1 304 kr
SFP 88-10-18L	5/8"	M 26x1,5	1 129 kr
SFP 88-10-22L	5/8"	M 30x2,0	1 557 kr
SFP 88-12-22L	3/4"	M 30x2,0	1 538 kr
SFP 88-16-28L	1"	M 36x2,0	2 007 kr
SFP 88-20-35L	1.1/4"	M 45x2,0	3 663 kr
SFP 88-24-42L	1.1/2"	M 52x2,0	5 248 kr
SFP 88-04-08S	1/4"	M 16x1,5	707 kr
SFP 88-04-10S	1/4"	M 18x1,5	707 kr
SFP 88-06-10S	3/8"	M 18x1,5	826 kr
SFP 88-06-12S	3/8"	M 20x1,5	826 kr
SFP 88-06-14S	3/8"	M 22x1,5	992 kr
SFP 88-08-16S	1/2"	M 24x1,5	1 006 kr
SFP 88-10-20S	5/8"	M 30x2,0	1 263 kr
SFP 88-12-20S	3/4"	M 30x2,0	1 538 kr
SFP 88-12-25S	3/4"	M 36x2,0	1 538 kr
SFP 88-16-25S	1"	M 36x2,0	1 818 kr
SFP 88-16-30S	1"	M 42x2,0	2 846 kr
SFP 88-20-38S	1.1/4"	M 52x2,0	4 297 kr

Rörstuds

Syrafast stål

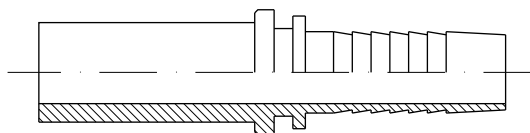

Typ: SFP 35

Beteckning	Slanginnerdiameter	Anslutning YD	Pris/st
SFP 35-03-06	3/16"	6	331 kr
SFP 35-03-08	3/16"	8	331 kr
SFP 35-04-06	1/4"	6	257 kr
SFP 35-04-08	1/4"	8	257 kr
SFP 35-04-10	1/4"	10	281 kr
SFP 35-06-10	3/8"	10	281 kr
SFP 35-06-12	3/8"	12	294 kr
SFP 35-06-14	3/8"	14	336 kr
SFP 35-06-15	3/8"	15	336 kr
SFP 35-08-15	1/2"	15	336 kr
SFP 35-08-16	1/2"	16	336 kr
SFP 35-08-18	1/2"	18	413 kr
SFP 35-10-18	5/8"	18	413 kr
SFP 35-10-20	5/8"	20	432 kr
SFP 35-10-22	5/8"	22	437 kr
SFP 35-12-20	3/4"	20	437 kr
SFP 35-12-22	3/4"	22	437 kr
SFP 35-12-25	3/4"	25	519 kr
SFP 35-16-25	1"	25	565 kr
SFP 35-16-28	1"	28	565 kr
SFP 35-16-30	1"	30	565 kr
SFP 35-20-35	1.1/4"	35	946 kr
SFP 35-20-38	1.1/4"	38	1 028 kr
SFP 35-24-42	1.1/2"	42	1 056 kr

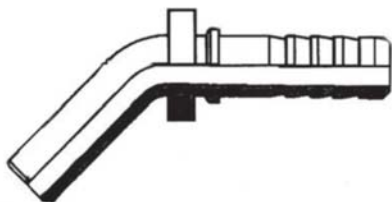

RÖRSTUDS 45°

Syrafast stål

Typ: SFP 36

Beteckning	Slanginnerdiameter	Anslutning YD	Pris/st
SFP 36-04-06	1/4"	6	746 kr
SFP 36-04-08	1/4"	8	727 kr
SFP 36-04-10	1/4"	10	746 kr
SFP 36-06-10	3/8"	10	764 kr
SFP 36-06-12	3/8"	12	764 kr
SFP 36-06-14	3/8"	14	838 kr
SFP 36 08-15	1/2"	15	887 kr
SFP 36-08-16	1/2"	16	857 kr
SFP 36-10-18	5/8"	18	1 063 kr
SFP 36-10-20	5/8"	20	1 155 kr
SFP 36-12-22	3/4"	22	1 360 kr
SFP 36-12-25	3/4"	25	1 584 kr
SFP 36-16-28	1"	28	1 958 kr
SFP 36-16-30	1"	30	2 759 kr
SFP 36-20-35	1.1/4"	35	2 975 kr
SFP 36-20-38	1.1/4"	38	4 660 kr
SFP 36-24-42	1.1/2"	42	4 846 kr

RÖRSTUDS 90°

Syrafast stål

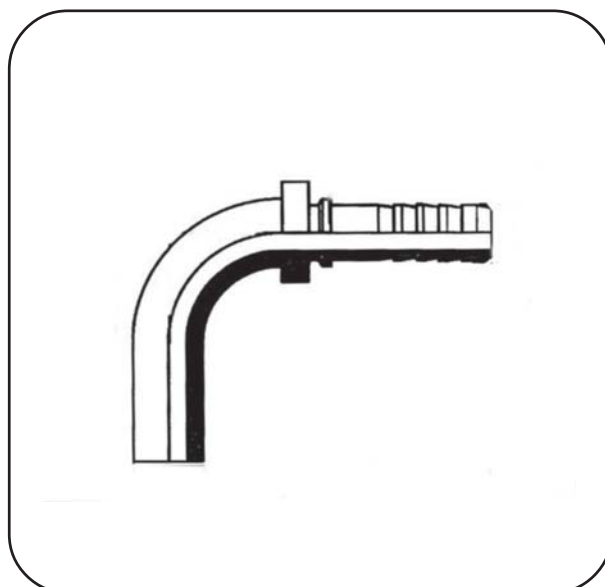

Typ: SFP 37

Beteckning	Slanginnerdiameter	Anslutning YD	Pris/st
SFP 37-04-06	1/4"	6	746 kr
SFP 37-04-08	1/4"	8	727 kr
SFP 37-04-10	1/4"	10	746 kr
SFP 37-06-10	3/8"	10	764 kr
SFP 37-06-12	3/8"	12	764 kr
SFP 37-06-14	3/8"	14	838 kr
SFP 37 08-15	1/2"	15	887 kr
SFP 37-08-16	1/2"	16	857 kr
SFP 37-10-18	5/8"	18	1 063 kr
SFP 37-10-20	5/8"	20	1 155 kr
SFP 37-12-22	3/4"	22	1 360 kr
SFP 37-12-25	3/4"	25	1 584 kr
SFP 37-16-28	1"	28	1 958 kr
SFP 37-16-30	1"	30	2 759 kr
SFP 37-20-35	1.1/4"	35	2 975 kr
SFP 37-20-38	1.1/4"	38	4 660 kr
SFP 37-24-42	1.1/2"	42	4 846 kr

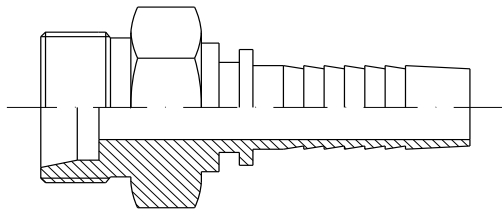

Rak koppling SK utvändig MM-gänga

Syrafast stål

Typ: SFP 85

Beteckning	Slanginnerdiameter	Anslutning	Pris/st
SFP 85-04-06L	1/4"	M 12x1,5	354 kr
SFP 85-04-08L	1/4"	M 14x1,5	354 kr
SFP 85-04-10L	1/4"	M 16x1,5	372 kr
SFP 85-06-10L	3/8"	M 16x1,5	372 kr
SFP 85-06-12L	3/8"	M 18x1,5	372 kr
SFP 85-06-15L	3/8"	M 22x1,5	413 kr
SFP 85-08-15L	1/2"	M 22x1,5	432 kr
SFP 85-08-18L	1/2"	M 26x1,5	468 kr
SFP 85-10-18L	5/8"	M 26x1,5	633 kr
SFP 85-10-22L	5/8"	M 30x2,0	776 kr
SFP 85-12-22L	3/4"	M 30x2,0	776 kr
SFP 85-16-28L	1"	M 36x2,0	1 171 kr
SFP 85-20-35L	1.1/4"	M 45x2,0	1 612 kr
SFP 85-24-42L	1.1/2"	M 52x2,0	2 277 kr
SFP 85-04-06S	1/4"	M 14x1,5	354 kr
SFP 85-04-08S	1/4"	M 16x1,5	354 kr
SFP 85-04-10S	1/4"	M 18x1,5	372 kr
SFP 85-06-10S	3/8"	M 18x1,5	376 kr
SFP 85-06-12S	3/8"	M 20x1,5	376 kr
SFP 85-06-14S	3/8"	M 22x1,5	496 kr
SFP 85-08-16S	1/2"	M 24x1,5	473 kr
SFP 85-10-20S	5/8"	M 30x2,0	533 kr
SFP 85-12-20S	3/4"	M 30x2,0	767 kr
SFP 85-12-25S	3/4"	M 36x2,0	767 kr
SFP 85-16-25S	1"	M 36x2,0	1 148 kr
SFP 85-16-30S	1"	M 42x2,0	1 148 kr
SFP 85-20-38S	1.1/4"	M 52x2,0	2 333 kr

Rak koppling invändig UNF-gänga

Syrafast stål

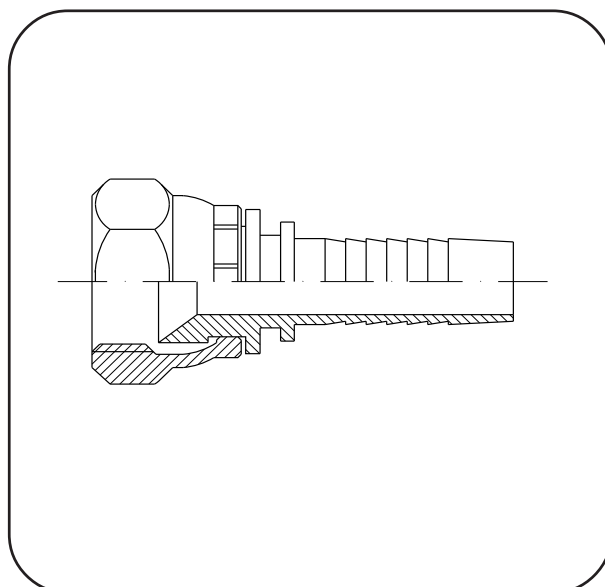

Typ: SFP 84

Beteckning	Slanginnerdiameter	Anslutning	Pris/st
SFP 84-04-07	1/4"	UNF 7/16"	511 kr
SFP 84-04-08	1/4"	UNF 1/2"	510 kr
SFP 84-04-09	1/4"	UNF 9/16"	510 kr
SFP 84-06-09	3/8"	UNF 9/16"	510 kr
SFP 84-06-12	3/8"	UNF 3/4"	510 kr
SFP 84-08-12	1/2"	UNF 3/4"	584 kr
SFP 84-08-14	1/2"	UNF 7/8"	666 kr
SFP 84-12-17	3/4"	UNF 1.1/16"	951 kr
SFP 84-12-19	3/4"	UNF 1.3/16"	969 kr
SFP 84-16-21	1"	UNF 1.5/16"	1 074 kr
SFP 84-20-26	1.1/4"	UNF 1.5/8"	1 735 kr
SFP 84-24-30	1.1/2"	UNF 1.7/8"	2 956 kr

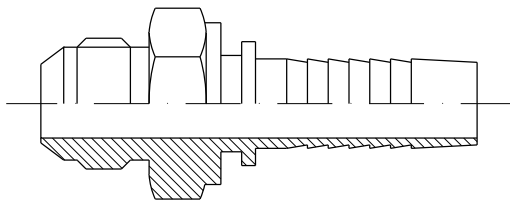

Rak koppling utvändig UNF-gänga

Syrafast stål

Typ: SFP 34

Beteckning	Slanginnerdiameter	Anslutning	Pris/st
SFP 34-04-07	1/4"	UNF 7/16"	441 kr
SFP 34-04-08	1/4"	UNF 1/2"	441 kr
SFP 34 04-09	1/4"	UNF 9/16	468 kr
SFP 34-06-09	3/8"	UNF 9/16"	446 kr
SFP 34-06-12	3/8"	UNF 3/4"	510 kr
SFP 34-08-12	1/2"	UNF 3/4"	510 kr
SFP 34-08-14	1/2"	UNF 7/8"	602 kr
SFP 34-10-14	5/8"	UNF 7/8"	620 kr
SFP 34-12-17	3/4"	UNF 1.1/16"	707 kr
SFP 34-12-19	3/4"	UNF 1.3/16"	859 kr
SFP 34-16-21	1"	UNF 1.5/16"	1 001 kr
SFP 34-20-26	1.1/4"	UNF 1.5/8"	1 961 kr
SFP 34-24-30	1.1/2"	UNF 1.7/8"	2 506 kr

Vinkelkoppling 90° invändig UNF-gänga

Syrafast stål

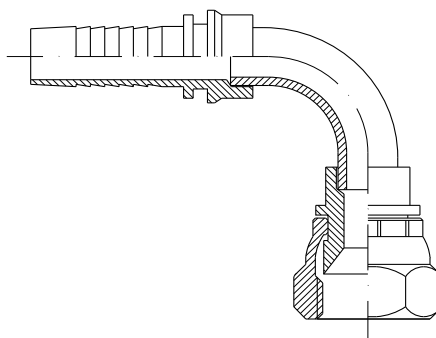

Typ: SFP 49

Beteckning	Slanginnerdiameter	Anslutning	Pris/st
SFP 49-04-07	1/4"	UNF 7/16"	565 kr
SFP 49-04-08	1/4"	UNF 1/2"	707 kr
SFP 49-04-09	1/4"	UNF 9/16"	749 kr
SFP 49-06-09	3/8"	UNF 9/16"	749 kr
SFP 49-06-12	3/8"	UNF 3/4"	786 kr
SFP 49-08-12	1/2"	UNF 3/4"	822 kr
SFP 49-08-14	1/2"	UNF 7/8"	822 kr
SFP 49-10-14	5/8"	UNF 7/8"	1 001 kr
SFP 49-12-17	3/4"	UNF 1.1/16"	1 148 kr
SFP 49-12-19	3/4"	UNF 1.3/16"	1 584 kr
SFP 49-16-21	1"	UNF 1.5/16"	1 584 kr
SFP 49-20-26	1.1/4"	UNF 1.5/8"	2 723 kr
SFP 49-24-30	1.1/2"	UNF 1.7/8"	3 696 kr

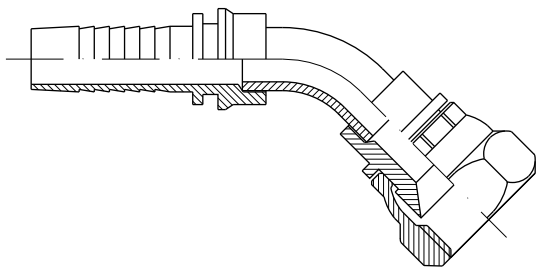

Vinkelkoppling 45° invändig UNF-gänga

Syrafast stål

Typ: SFP 50

Beteckning	Slanginnerdiameter	Anslutning	Pris/st
SFP 50-04-07	1/4"	UNF 7/16"	643 kr
SFP 50-04-08	1/4"	UNF 1/2"	643 kr
SFP 50-04-09	1/4"	UNF 9/16"	643 kr
SFP 50-06-09	3/8"	UNF 9/16"	648 kr
SFP 50-06-12	3/8"	UNF 3/4"	679 kr
SFP 50-08-12	1/2"	UNF 3/4"	679 kr
SFP 50-08-14	1/2"	UNF 7/8"	826 kr
SFP 50-10-14	5/8"	UNF 7/8"	832 kr
SFP 50-12-17	3/4"	UNF 1.1/16"	1 138 kr
SFP 50-12-19	3/4"	UNF 1.3/16"	1 584 kr
SFP 50-16-21	1"	UNF 1.5/16"	1 584 kr
SFP 50-20-26	1.1/4"	UNF 1.5/8"	2 723 kr
SFP 50-24-30	1.1/2"	UNF 1.7/8"	3 696 kr

Rak koppling utvändig NPT-gänga

Syrafast stål

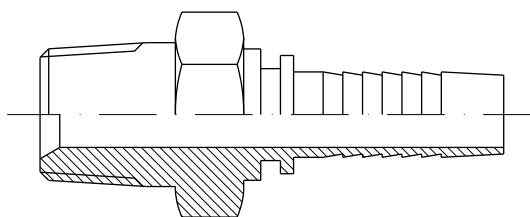

Typ: SFP 6

Beteckning	Slanginnerdiameter	Anslutning	Pris/st
SFP 6-04	1/4"	NPTF 1/4"	365 kr
SFP 6-06-04	3/8"	NPTF 1/4"	365 kr
SFP 6-06	3/8"	NPTF 3/8"	357 kr
SFP 6-06-08	3/8"	NPTF 1/2"	490 kr
SFP 6-08	1/2"	NPTF 1/2"	451 kr
SFP 6-10	5/8"	NPTF 5/8"	639 kr
SFP 6-12	3/4"	NPTF 3/4"	639 kr
SFP 6-16	1"	NPTF 1"	942 kr
SFP 6-20	1.1/4"	NPTF 1.1/4"	1 639 kr
SFP 6-24	1.1/2"	NPTF 1.1/2"	2 121 kr
SFP 6-32	2"	NPTF 2"	3 503 kr

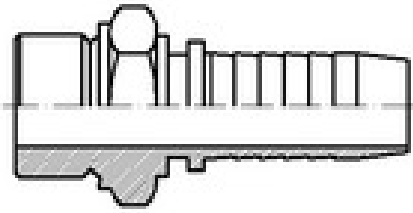

Rak koppling

Utvändig Plan BSPP-gäng

Syrafäst stål

Typ: SFP 4

Beteckning	Slanginnerdiameter	Anslutning	Pris/st
SFP 4-04-02	1/4"	G 1/8"	Plan Tätyta 386 kr
SFP 4-04	1/4"	G 1/4"	Plan Tätyta 427 kr
SFP 4-06	3/8"	G 3/8"	Plan Tätyta 412 kr
SFP 4-06-04	3/8"	G 1/4"	Plan Tätyta 508 kr
SFP 4-08	1/2"	G 1/2"	Plan Tätyta 488 kr
SFP 4-08-06	1/2"	G 3/8"	Plan Tätyta 496 kr
SFP 4-08-12	1/2"	G 3/4"	Plan Tätyta 862 kr
SFP 4-10	5/8"	G 5/8"	Plan Tätyta 792 kr
SFP 4-10-12	5/8"	G 3/4"	Plan Tätyta 678 kr
SFP 4-12	3/4"	G 3/4"	Plan Tätyta 678 kr
SFP 4-12-16	3/4"	G 1"	Plan Tätyta 1 053 kr
SFP 4-16	1"	G 1"	Plan Tätyta 1 053 kr
SFP 4-16-20	1"	G 1.1/4"	Plan Tätyta 2 338 kr
SFP 4-20	1.1/4"	G 1.1/4"	Plan Tätyta 2 215 kr
SFP 4-24	1.1/2"	G 1.1/2"	Plan Tätyta 2 439 kr
SFP 4-32	2"	G 2"	Plan Tätyta 4 025 kr

Rak koppling

Utvändig BSPT-gäng

Syrafast stål

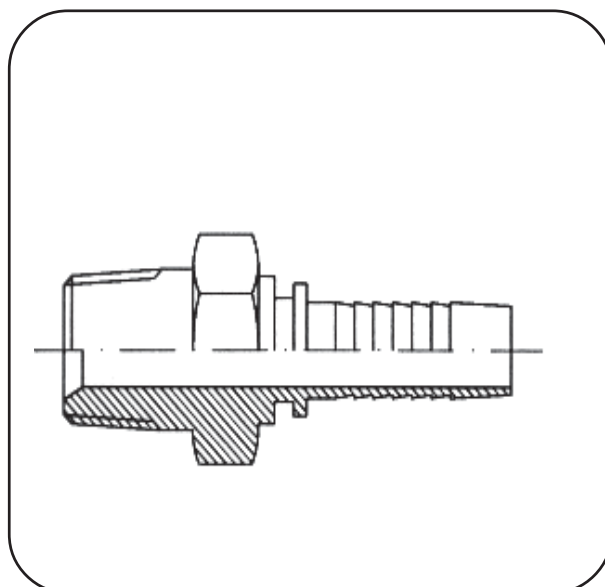

Typ: SFP 9

Beteckning	Slanginnerdiameter	Anslutning	Pris/st
SFP 9-04-02	1/4"	KR 1/8"	320 kr
SFP 9-04	1/4"	KR 1/4"	339 kr
SFP 9-06	3/8"	KR 3/8"	376 kr
SFP 9-06-08	3/8"	KR 1/2"	547 kr
SFP 9-08	1/2"	KR 1/2"	450 kr
SFP 9-08-06	1/2"	KR 3/8"	450 kr
SFP 9-08-12	1/2"	KR 3/4"	766 kr
SFP 9-10-12	5/8"	KR 3/4"	694 kr
SFP 9-12	3/4"	KR 3/4"	663 kr
SFP 9-12-16	3/4"	KR 1"	1 150 kr
SFP 9-16	1"	KR 1"	1 063 kr
SFP 9-20	1.1/4"	KR 1.1/4"	1 695 kr
SFP 9-24	1.1/2"	KR 1.1/2"	2 263 kr
SFP 9-32	2"	KR 2"	3 817 kr

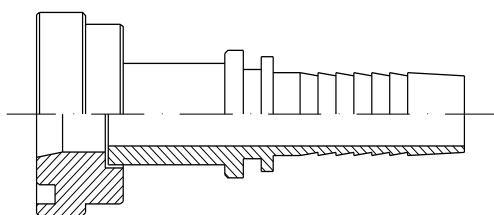

Rak koppling SAE 3000 SAE 6000

Syrafast stål

Typ: SFP 603 och 606

Beteckning	Slanginnerdiameter	Flänsstorlek	SAE	Pris/st
SFP 603-08	1/2"	1/2"	3000	909 kr
SFP 603-08-12	1/2"	3/4"		1 304 kr
SFP 603-12	3/4"	3/4"		1 089 kr
SFP 603-12-16	3/4"	1"		1 263 kr
SFP 603-16	1"	1"		1 263 kr
SFP 603-16-20	1"	1.1/4"		1 845 kr
SFP 603-20	1.1/4"	1.1/4"		1 845 kr
SFP 603-20-24	1.1/4"	1.1/2"		2 337 kr
SFP 603-24	1.1/2"	1.1/2"		2 337 kr
SFP 603-32	2"	2"		3 865 kr
SFP 606-08	1/2"	1/2"	6000	1 020 kr
SFP 606-08-12	1/2"	3/4"		1 162 kr
SFP 606-12	3/4"	3/4"		1 162 kr
SFP 606-12-16	3/4"	1"		1 327 kr
SFP 606-16	1"	1"		1 327 kr
SFP 606-16-20	1"	1.1/4"		1 942 kr
SFP 606-20	1.1/4"	1.1/4"		1 942 kr
SFP 606-20-24	1.1/4"	1.1/2"		2 736 kr
SFP 606-24	1.1/2"	1.1/2"		2 736 kr
SFP 606-32	2"	2"		4 082 kr

Vinkelkoppling 90° SAE 3000 SAE 6000

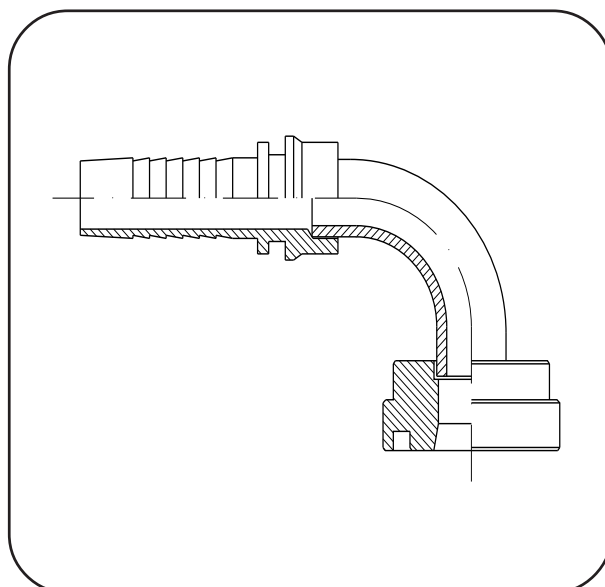

Syrafast stål

Typ: SFP 613 och 616

Beteckning	Slanginnerdiameter	Flänsstorlek	SAE	Pris/st
SFP 613-08	1/2"	1/2"	3000	1 263 kr
SFP 613-08-12	1/2"	3/4"		1 658 kr
SFP 613-12	3/4"	3/4"		1 496 kr
SFP 613-12-16	3/4"	1"		1 597 kr
SFP 613-16	1"	1"		1 597 kr
SFP 613-16-20	1"	1.1/4"		3 085 kr
SFP 613-20	1.1/4"	1.1/4"		3 085 kr
SFP 613-20-24	1.1/4"	1.1/2"		4 082 kr
SFP 613-24	1.1/2"	1.1/2"		4 082 kr
SFP 613-32	2"	2"		5 440 kr
SFP 616-08	1/2"	1/2"	6000	1 263 kr
SFP 616-08-12	1/2"	3/4"		1 658 kr
SFP 616-12	3/4"	3/4"		1 658 kr
SFP 616-12-16	3/4"	1"		2 139 kr
SFP 616-16	1"	1"		2 139 kr
SFP 616-16-20	1"	1.1/4"		3 384 kr
SFP 616-20	1.1/4"	1.1/4"		3 384 kr
SFP 616-20-24	1.1/4"	1.1/2"		4 664 kr
SFP 616-24	1.1/2"	1.1/2"		4 664 kr
SFP 616-32	2"	2"		5 624 kr

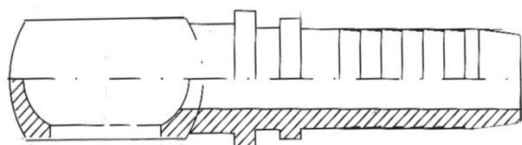

Banjokoppling

Syrafast stål

Typ: SFP 81

Beteckning	Slanginnerdiameter	Anslutning	Pris/st
SFP81-04	1/4"	1/4"	693 kr
SFP81-06	3/8"	3/8"	803 kr
SFP81-08	1/2"	1/2"	1 160 kr
SFP81-12	3/4"	3/4"	1 401 kr
SFP81-M10	1/4"	M10X1 + 1/8"	693 kr
SFP81-M12	1/4"	M12X1,5	641 kr
SFP81-M14	3/8"	M14X1,5	829 kr
SFP81-M16	3/8"	M16X1,5	803 kr
SFP81-M18	3/8"	M18X1,5	1 134 kr
SFP81-M22	1/2"	M22X1,5	1 160 kr
SFP81-M26	3/4"	M26X1,5	1 401 kr

Banjoskruv Banjohuvud RGN

Syrafast stål

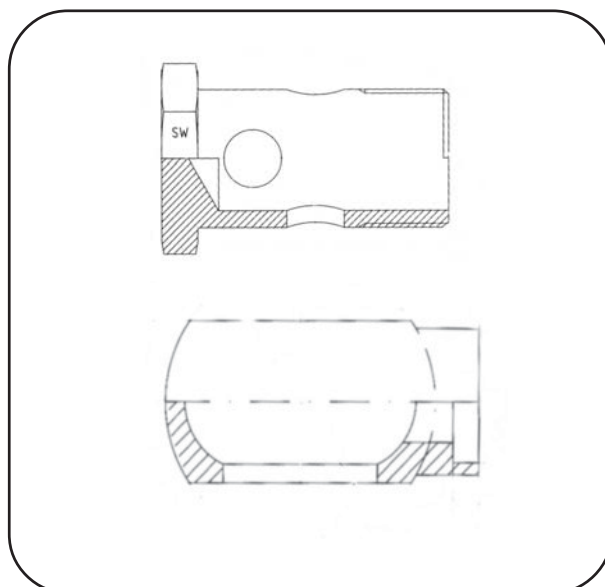

Typ: SFP 181

RGN

Beteckning	Rördim	Anslutning	Pris/st
SFP 181-02		1/8"	330 kr
SFP 181-04		1/4"	330 kr
SFP181-06		3/8"	323 kr
SFP181-08		1/2"	295 kr
SFP181-12		3/4"	645 kr
SFP181-M10		M10X1	330 kr
SFP181-M12		M12X1,5	330 kr
SFP181-M14		M14X1,5	274 kr
SFP181-M16		M16X1,5	274 kr
SFP181-M18		M18X1,5	306 kr
SFP181-M22		M22X1,5	368 kr
SFP181-M26		M26X1,5	832 kr
RGN-06	6 MM	M10X1 + 1/8"	702 kr
RGN-08	8 MM	M12X1,5	747 kr
RGN-10	10MM	M14X1,5	762 kr
RGN-12	12 MM	M16X1,5 + 3/8"	829 kr
RGN-15	15 MM	M18X1,5	1 016 kr
RGN-18	18 MM	M22X1,5	2 116 kr
RGN-22	22 MM	M26X1,5 + 3/4"	2 696 kr

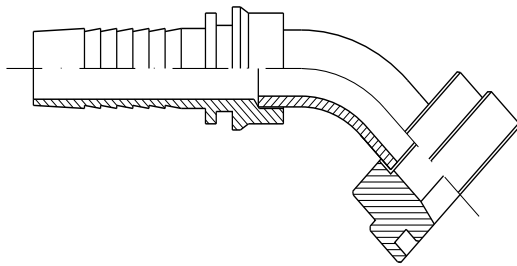

Vinkelkoppling 45° SAE 3000 SAE 6000

Syrafast stål

Typ: SFP 623 och 626

Beteckning	Slanginnerdiameter	Flänsstorlek	SAE	Pris/st
SFP 623-08	1/2"	1/2"	3000	1 263 kr
SFP 623-08-12	1/2"	3/4"		1 658 kr
SFP 623-12	3/4"	3/4"		1 496 kr
SFP 623-12-16	3/4"	1"		1 597 kr
SFP 623-16	1"	1"		1 597 kr
SFP 623-16-20	1"	1.1/4"		3 090 kr
SFP 623-20	1.1/4"	1.1/4"		3 090 kr
SFP 623-20-24	1.1/4"	1.1/2"		4 082 kr
SFP 623-24	1.1/2"	1.1/2"		4 082 kr
SFP 623-32	2"	2"		5 440 kr
SFP 626-08	1/2"	1/2"	6000	1 263 kr
SFP 626-08-12	1/2"	3/4"		1 658 kr
SFP 626-12	3/4"	3/4"		1 658 kr
SFP 626-12-16	3/4"	1"		2 139 kr
SFP 626-16	1"	1"		2 139 kr
SFP 626-16-20	1"	1.1/4"		3 384 kr
SFP 626-20	1.1/4"	1.1/4"		3 384 kr
SFP 626-20-24	1.1/4"	1.1/2"		4 664 kr
SFP 626-24	1.1/2"	1.1/2"		4 664 kr
SFP 626-32	2"	2"		5 624 kr

Hylsor 1w 2w

Syrafast stål

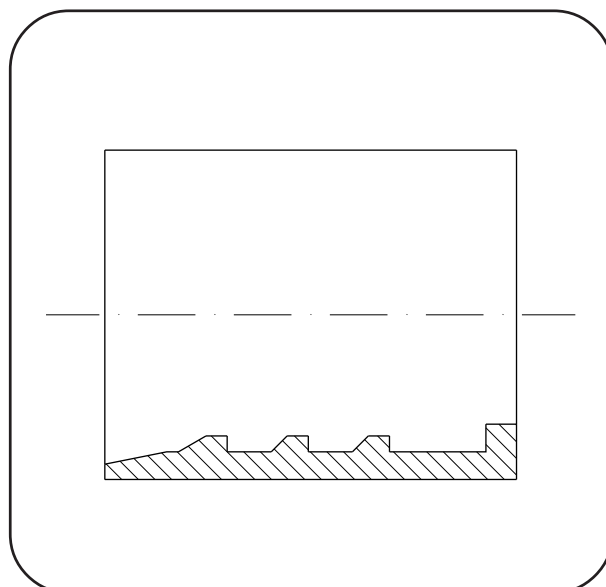

Typ: SFP 20 och 10

Beteckning	Typ	Slangdiameter	Pris/st
SFP 10T-04	1+2W	1/4"	235 kr
SFP 20-06	2W	3/8"	235 kr
SFP 20-08	2W	1/2"	290 kr
SFP 20-10	2W	5/8"	382 kr
SFP 20-12	2W	3/4"	529 kr
SFP 20-16	2W	1"	685 kr
SFP 20-20	2W	1.1/4"	874 kr
SFP 20-24	2W	1.1/2"	1 184 kr
SFP 20-32	2W	2"	1 845 kr
SFP 10-16	1W	1"	685 kr
SFP 10-20	1W	1.1/4"	874 kr
SFP 10-24	1W	1.1/2"	1 184 kr
SFP 10-32	1W	2"	1 845 kr

Andra hylsor på förfrågan

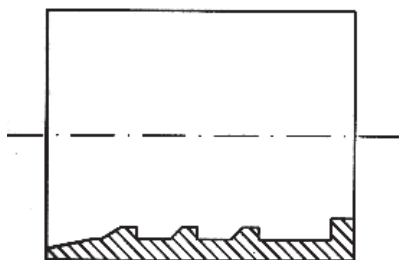

Hylsa Skalfri för R1-R2

Syrafast stål

Typ: SFP-T

Beteckning	Typ	Slangdiameter	Pris/st
SFP 10T-04	1+2W	1/4"	235 kr
SFP 10T-06	1W	3/8"	235 kr
SFP 10T-08	1W	1/2"	290 kr
SFP 10T-10	1W	5/8"	382 kr
SFP 10T-12	1W	3/4"	529 kr
SFP 10T-16	1W	1"	685 kr
SFP 20T-06	2W	3/8"	236 kr
SFP 20T-08	2W	1/2"	290 kr
SFP 20T-10	2W	5/8"	381 kr
SFP 20T-12	2W	3/4"	528 kr
SFP 20T-16	2W	1"	685 kr

Hylsa för R7-slang för PTFE-slang

Syrafast stål

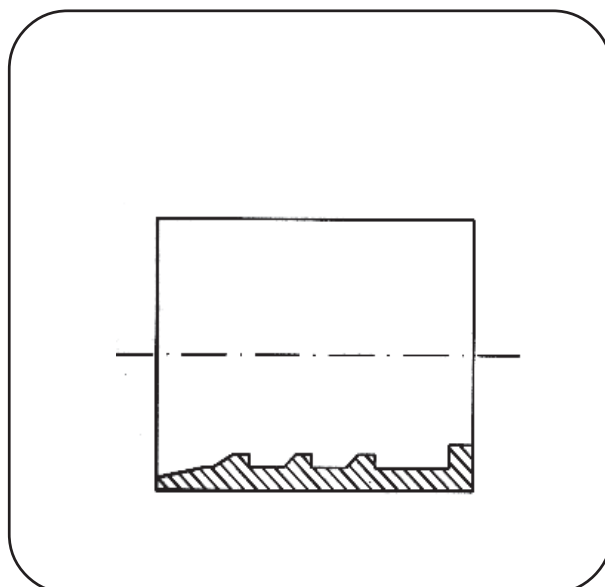

Typ: SFPR7 PTFE

Beteckning	Typ	Slangdiameter	Pris/st
PTFE-04	PTFE-SLANG	1/4"	235 kr
PTFE-06	PTFE-SLANG	3/8"	235 kr
PTFE-08	PTFE-SLANG	1/2"	290 kr
PTFE-10	PTFE-SLANG	5/8"	382 kr
PTFE-12	PTFE-SLANG	3/4"	529 kr
PTFE-16	PTFE-SLANG	1"	685 kr
SFPR7-04	SAE 100 R7	1/4"	235 kr
SFPR7-06	SAE 100 R7	3/8"	235 kr
SFPR7-08	SAE 100 R7	1/2"	290 kr
SFPR7-10	SAE 100 R7	5/8"	382 kr
SFPR7-12	SAE 100 R7	3/4"	529 kr
SFPR7-16	SAE 100 R7	1"	685 kr